

FRONT ELEVATION
SCALE=1:100

SECTION AT A-A'
SCALE=1:100

SECTION AT B-B'
SCALE=1:100

ARCHITECTURAL DRAWING
PROPOSED G+III STORED RESIDENTIAL BUILDING PLAN AT HOLDING NO. - 145, MOUZA- LASKARPUR, DAG NO. - R.S-919/1432(p), KHATIAN NO.-R.S-67 P.S.-SONAR PUR, UNDER RAJPUR WARD NO.-31, SONARPUR MUNICIPALITY.
AREA STATEMENT: [L.R. KHATIAN NO.-2274, L.R. DAG NO.-1120.]
 AREA OF LAND (AS PER DEED): 330.267 SQM. (04 K-15 CH-00 SFT.)
 AREA OF LAND (AS PER PHY): 339.141 SQM. (05 K-00 CH-40 SFT.)
 STRIP OF LAND RELEASED: 7.875 SQM.
 AREA AFTER RELEASE: 330.266 SQM. (04 K-15 CH-00 SFT.)
 PERMISSIBLE GROUND COVERAGE: (58.487%) - 193.163 SQM.
 PROPOSED GROUND COVERAGE: (58.487%) - 193.163 SQM.
 PERMISSIBLE F.A.R. - 1.75
 PERMISSIBLE HEIGHT OF BUILDING: 11.5 M.
 PROPOSED HEIGHT OF BUILDING: 11.5 M.
 NO OF FLATS: 09
 NO OF SHOPS: NIL
 TOTAL NO. OF PARKING PROVIDED: 06 NOS.
 SERVICE AREA: 15.228 SQM.
 COMMERCIAL AREA: 18.562 SQM.

AREA CALCULATION

FLOOR	1	2	3	4	5	7	8	9	10	11	12
	AREA (SQM)	LIFT WELL + STAIR DUCT (SQM)	ACTUAL AREA WITHOUT DUCT (SQM)	RESI. MANDATORY STAIR AREA (INSIDE) (SQM)	COMMERCIAL MANDATORY STAIR AREA (INSIDE) (SQM)	LIFT LOBBY AREA (SQM)	AREA EXCLUDING LIFT/LIFT LOBBY/STAIR (SQM)	COMMERCIAL AREA (SQM)	CAR PARKING AREA (SQM)	CUP BOARD/ LOFT AREA (SQM)	ACTUAL AREA AFTER DEDUCTION (SQM)
GROUND FLOOR	191.167	NIL	191.167	12.285	NIL	1.80	178.207	18.562	129.311	NIL	47.771
1ST FLOOR	191.167	2.925	188.242	11.160	NIL	1.80	175.282	NIL	NIL	3.325	175.282
2ND FLOOR	191.167	2.925	188.242	11.160	NIL	1.80	175.282	NIL	NIL	3.325	175.282
3RD FLOOR	191.167	2.925	188.242	11.160	NIL	1.80	175.282	NIL	NIL	3.325	175.282
TOTAL	764.668	8.775	755.893	48.015	NIL	7.20	704.053	18.562	129.311	9.975	573.617

RESIDENTIAL PARKING CALCULATION:
 PARKING REQUIRED FOR RESIDENTIAL AREA = ACTUAL RESIDENTIAL AREA / 150
 (AREA OF FLAT - A + FLAT - B + FLAT - C) X3 SQM./150
 = (50.956 SQM. + 58.717 SQM. + 63.196 SQM.) X3 = 518.607 SQM./150 = 3.457 NOS. SAY 03 NOS.
COMMERCIAL PARKING CALCULATION:
 PARKING REQUIRED FOR 18.562 SQM. COMMERCIAL AREA = NIL
TOTAL REQUIRED PARKING = 3 NOS = 75 SQM.
F.A.R. CALCULATION:
 TOTAL AREA EXCLUDING (LIFT/DUCT/LIFT LOBBY/STAIR/CAR PARKING) = 573.617 SQM.
 PROPOSED F.A.R. = 573.617 / 330.267 = 1.737
 C.B. AREA = 9.975 SQM. (1.32 %)
 TOTAL FLOOR AREA EXCLUDING C.B. = 755.893 SQM.
 TOTAL FLOOR AREA INCLUDING C.B. = 765.868 SQM.

DOOR & WINDOW SCHEDULE :

MKD.	SIZE	MKD.	SIZE	MKD.	SIZE
D	1200X2100	W1	1500X1350	W4	900X1050
D1	900X2100	W2	1200X1350	W5	800X600
D2	750X2100	W3	900X1350		
SD1	2360X2100				

- NOTES & SPECIFICATIONS**
- 75 TH. 1ST CLASS BRICK SOLING IN FOUNDATION & FLOOR.
 - 150 TH. 1:3:6 (CEMENT, SAND & KHOA) CEMENT CONCRETE IN FOUNDATION & FLOOR.
 - FOUNDATION BRICK WORK WILL BE 1ST CLASS BRICK WITH 1:6 CEMENT MORTAR.
 - 125 TH. & 75 TH. PARTITION BRICK WORK WILL BE 1:5 CEMENT MORTAR.
 - 200TH. EXTERNAL WALLS WILL BE 1:6 CEMENT MORTAR.
 - 25 TH. D.P.C WILL BE 1:2:4 WITH PROPER WATER PROOFING COMPOUND.
 - R.C.C. CONC. MIX WILL BE 1:2:4 CEMENT SAND & STONE CHIPS.
 - ROOF AND LIME TERRACING WILL BE 100 TH. WITH THEIR PROPER MATERIALS AND MIXING.
 - CEILING AND ALL R.C. PLASTER WILL BE 12mm. TH. 1:4 CEMENT MORTAR.
 - 25 MM. TH. I.P.S. FLOORING.
 - GRADE OF CONCRETE - M - 20.
 - ALL BUILDING MATERIALS WILL BE AS PER I.S. CODE & C.B.C. 1984.
 - ALL C.B. 150 UP FROM FLOOR LEVEL.

(Signature)
(ASHIM KUMAR MAZUMDER)
 As Constituted Attorney of
SALMAN DAS

CERTIFICATE OF STRUCTURAL ENGINEER :
 THE STRUCTURAL DESIGN AND DRAWING OF BOTH FOUNDATION AND SUPER STRUCTURE OF THE BUILDING HAS BEEN MADE BY ME CONSIDERING ALL POSSIBLE LOADS INCLUDING THE SEISMIC LOAD AS PER NATIONAL BUILDING CODE OF INDIA AND CERTIFIED THAT IT IS SAFE AND STABLE IN ALL RESPECT.

DECLARATION OF E.B.S. CL-1 :
 CERTIFIED WITH FULL RESPONSIBILITY THAT THE BUILDING PLAN HAS BEEN DRAWN UP AS PER PROVISIONS OF RAJPUR SONARPUR MUNICIPALITY BUILDING RULE 1996 AS AMENDED FROM TIME TO TIME & SITE CONDITIONS INCLUDING THE WIDTH OF ROAD CONFORM WITH THE PLAN PLOT IS DEMARCATED BY BOUNDARY WALL & IT IS A BUILD ABLE, SITE NOT A TANK OR FILLED UP TANK.

USED SCALE: 1:25, 1:50, 1:100, 1:400

OFFICE USE ONLY

APPROVED
 Plan No. 79/CS/30/31 Date: 04/07/2022
 Valid Upto: 04/07/2022
 Checked by: *(Signature)*
 Local Office Engineer: *(Signature)*
RAJPUR SONARPUR MUNICIPALITY

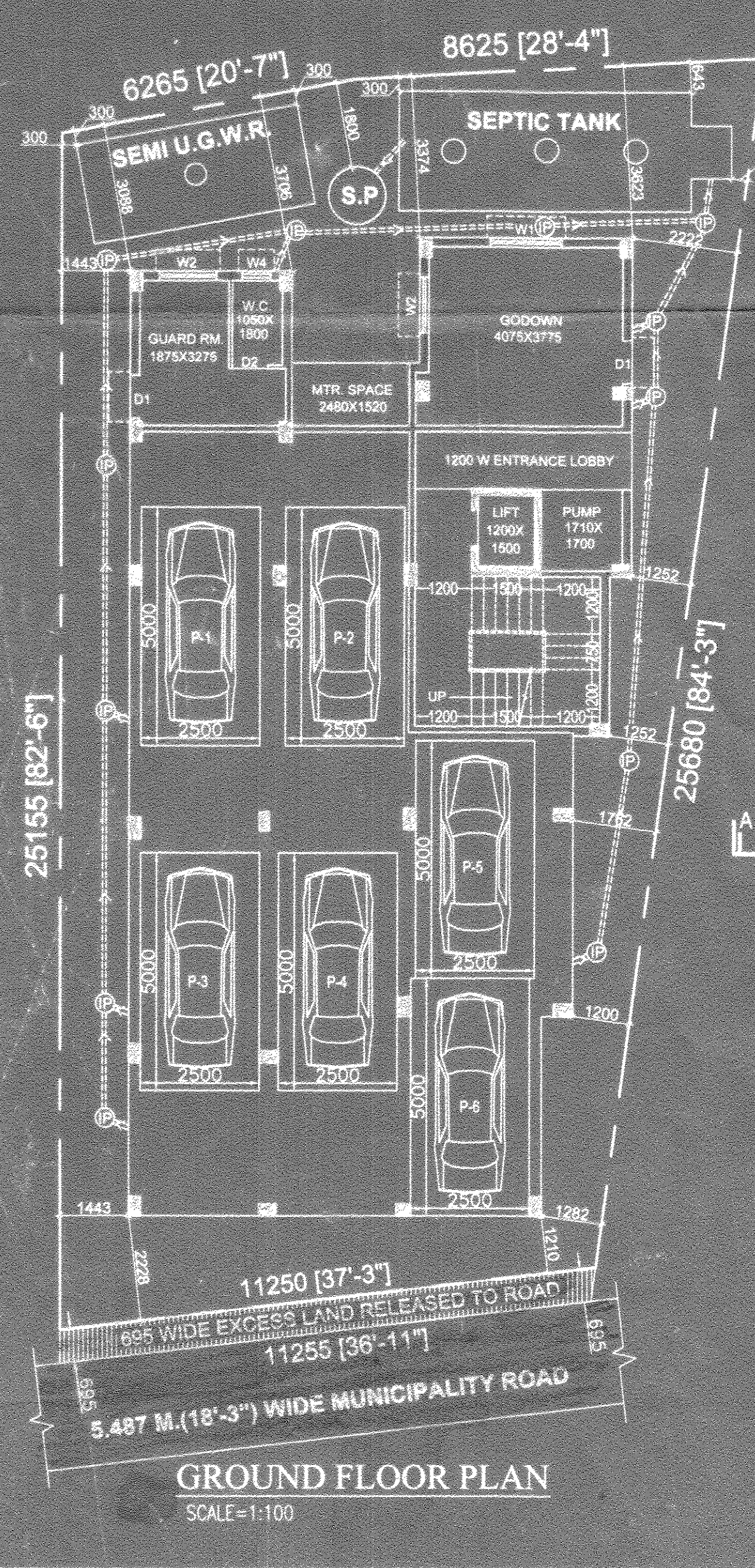

GROUND FLOOR PLAN
SCALE=1:100

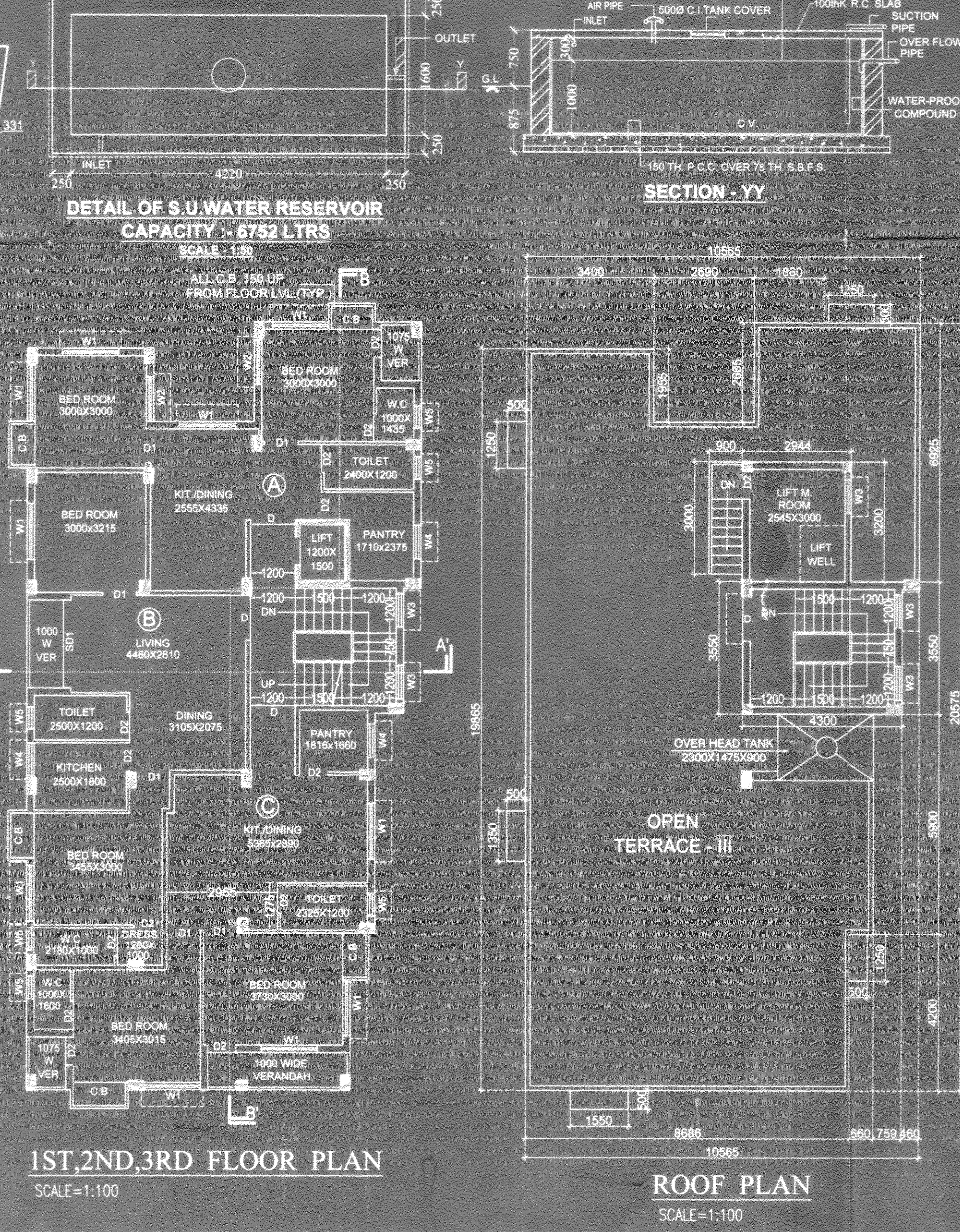

1ST, 2ND, 3RD FLOOR PLAN
SCALE=1:100

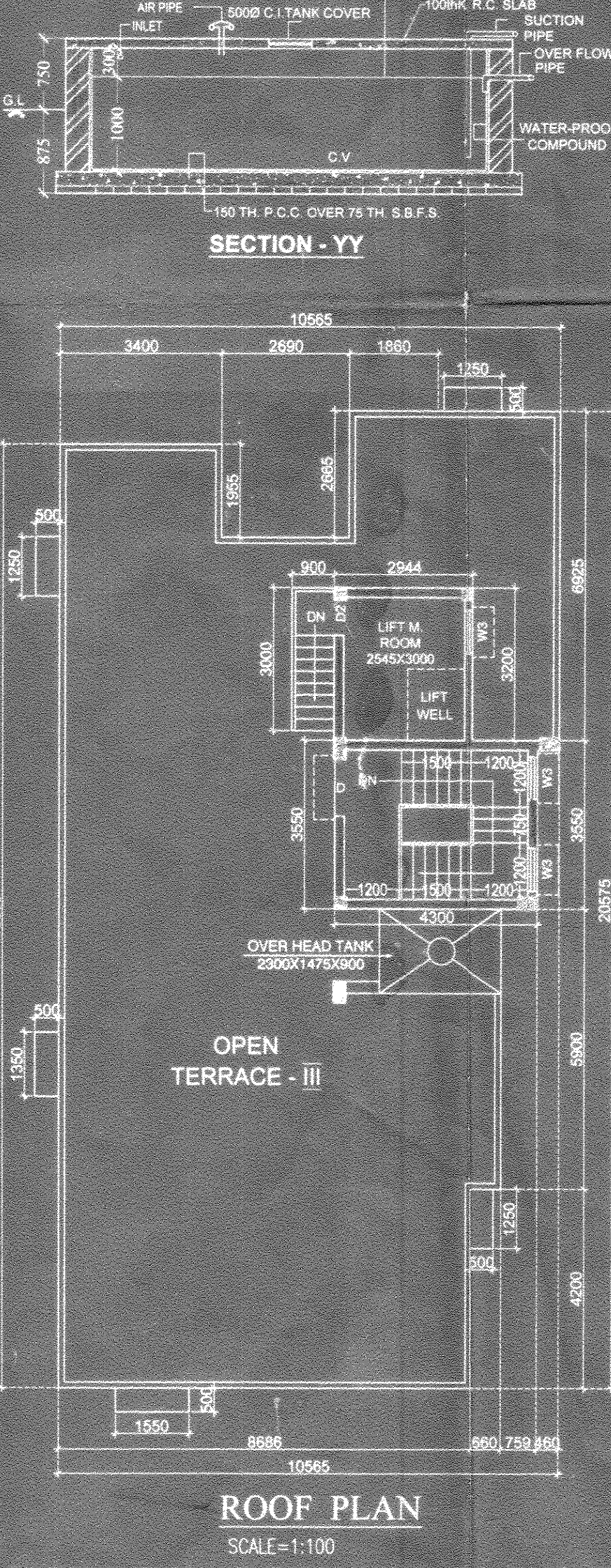

ROOF PLAN
SCALE=1:100

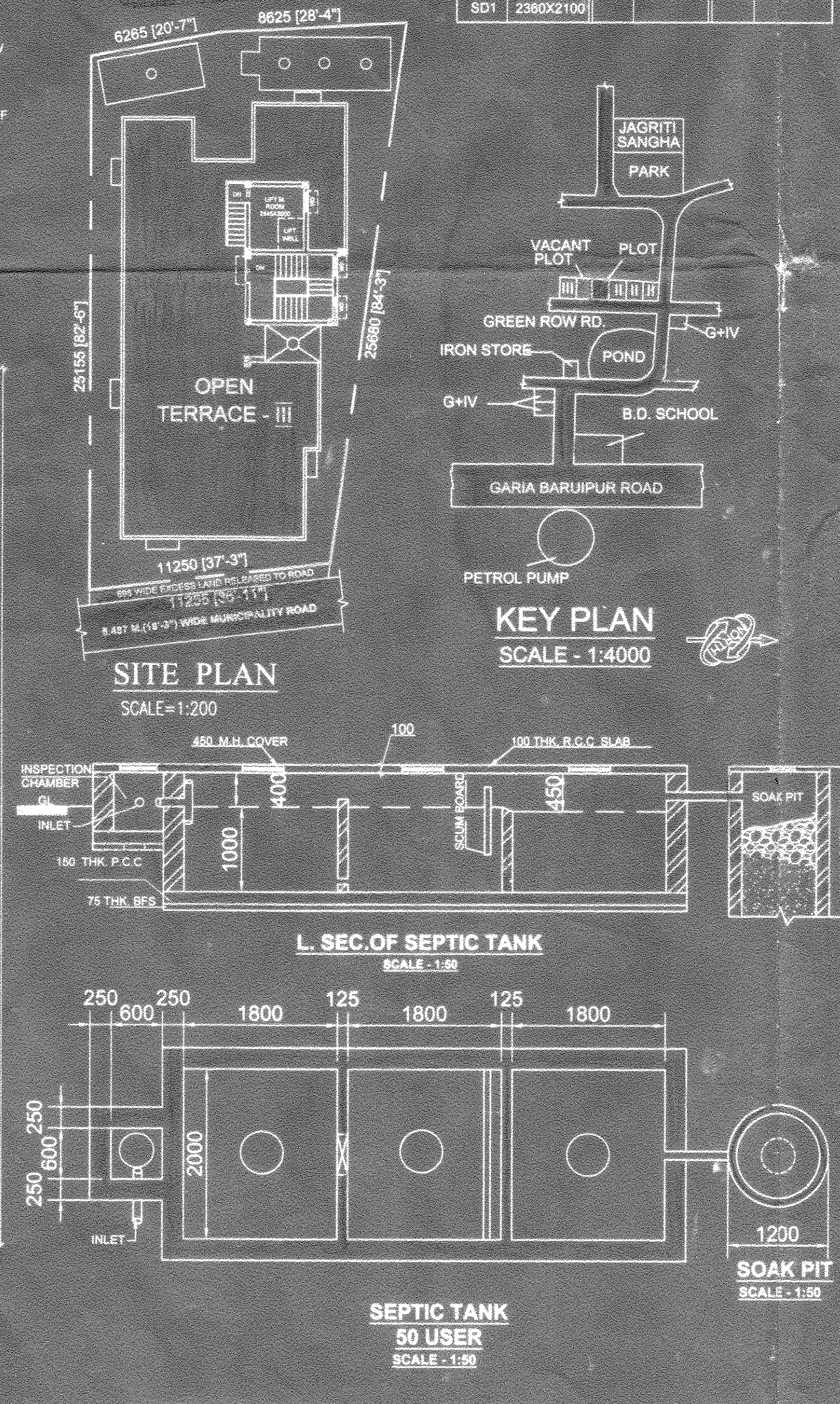

SITE PLAN
SCALE=1:200

KEY PLAN
SCALE - 1:4000

L. SEC. OF SEPTIC TANK
SCALE: 1:50

SEPTIC TANK 50 USER
SCALE: 1:50

SOAK PIT
SCALE: 1:50

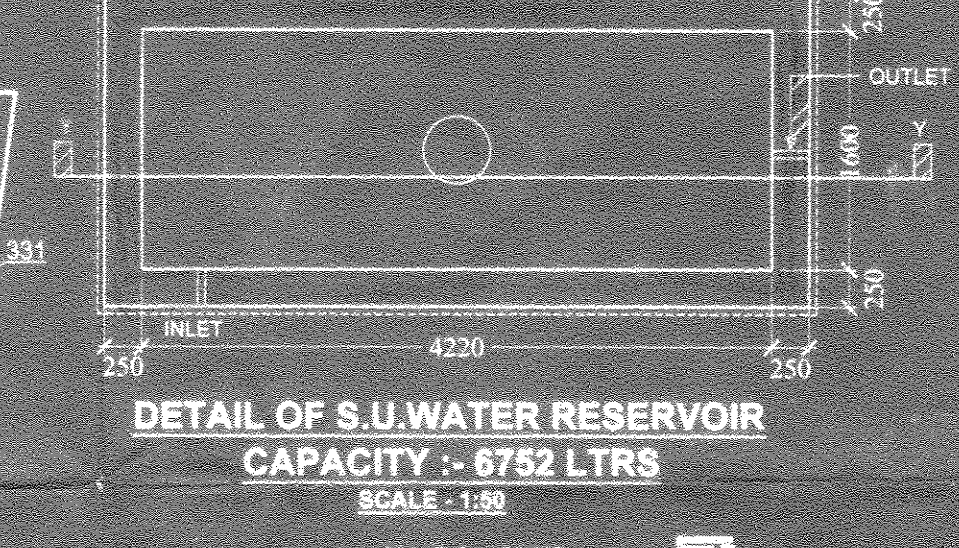

DETAIL OF S.U. WATER RESERVOIR
CAPACITY :- 6752 LTRS
SCALE: 1:50

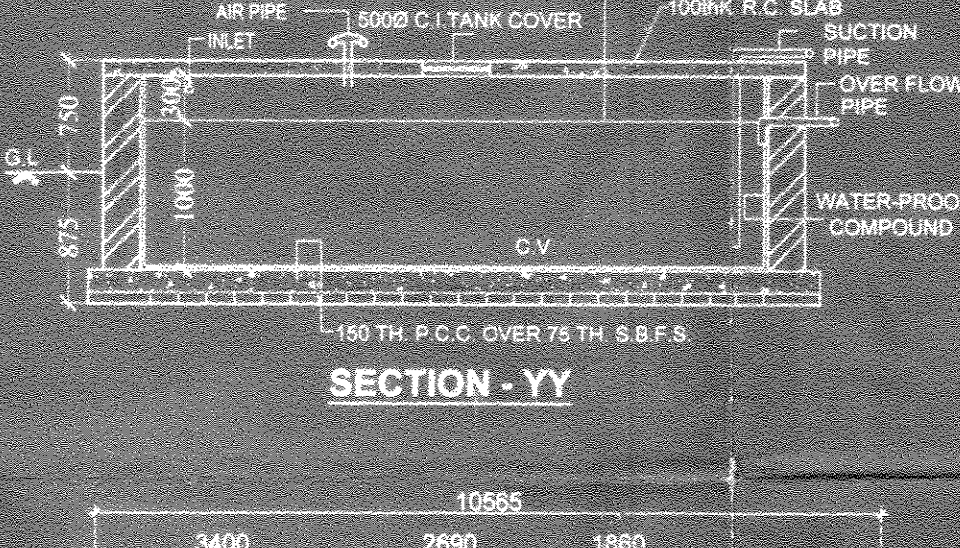

SECTION - YY